

## Table top Commercial Gas CharBoiler

### PARAMETERS SHEET

MODEL#: TFCB SERIES



**MODEL # TFCB-24-RH**

### Specifications

- Stainless steel body
- Cast iron gas burner
- CSA approved Gas Valve
- Manual ignition
- With Pilot Switch

### Choose GAS TYPE When Placing Order

- LPG**  
Liquefied Propane Gas
- Town Gas**

### Models in TFCBseries

- TFCB-24-RH**
- TFCB-36-RH**
- TFCB-48-RH**

### Standard Accessories

- Adjustable bullet leg
- Convert kit of LP gas and NG

### PRODUCT DIMENSION CHART

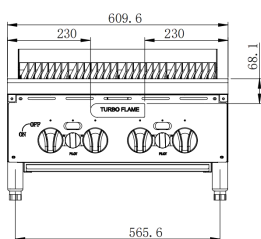

**TFCB-24-RH**

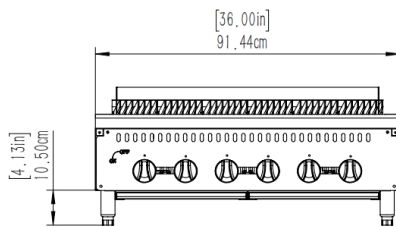

**TFCB-36-RH**

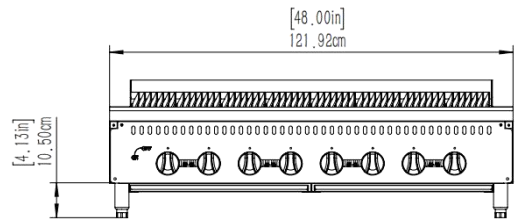

**TFCB-48-RH**

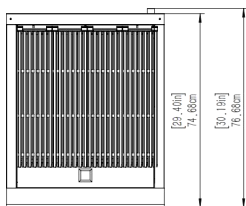

**Top View**

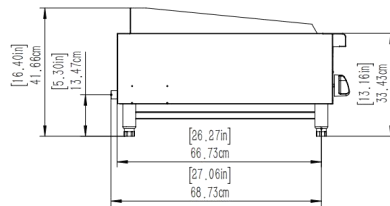

**Side View**

### Key Parameters

Model	Product Dimension	Heat Power	Heating Burner	Gas Consumption	Gas inlet Connection	N.W	G.W	Packing dimension
TFCB-24-RH	24x29.05x16.38 inch 609.6x737.8x416mm	80,000 BTU/H	4	LPG: 0.906m3/h Town Gas: 2.104m3/h	3/4" NPT Male	89.5kg	105.5kg	740X890X500mm
TFCB-36-RH	36x29.05x16.38 inch 915x737.8x416mm	120,000 BTU/H	6	LPG: 1.36m3/h Town Gas: 3.156m3/h	3/4" NPT Male	124.5kg	150kg	1050x890x500mm
TFCB-48-RH	48x29.05x16.38 inch 1210x737.8x416mm	160,000 BTU/H	8	LPG: 1.813m3/h Town Gas: 4.209m3/h	3/4" NPT Male	159kg	194kg	1340x890x500mm