



www.kxports.com

QUALITY TO RELY ON

Keeping food freshest at all times!



- ✓ Turbo Performance
- ✓ Fast Cooling & Recovery
- ✓ Easy Maintainance
- ✓ User Friendly





www.kxports.com

About Us

Turbo Freeze is a Home Grown Singapore Company that started Manufacturing Commercial Refrigerator using the most traditional handmade method from nothing to a product, we have definitely gained extensive experience & expertise since then. Today, Turbo Freeze is unleashing its potential in system design in to South East Asia Market to help customers cut down after sales problems using our refrigerator.

Over the years, we have also apply our knowledge & experience gained thru user comment, engineering upgrade & technology advancement to make mission impossible designs to take over tradiional design which is capable to be more efficient in overall performance. Our objective here is never to compete in pricing but to provide solutions to customers who believes us.

Looking ahead, Turbo Freeze aims to build quality commercial refrigeration products that is affordable, robust, high in performance, user friendly for both user & technical support.



Commercial Refrigerator & Freezers

Delivering superior performance to the World.



Top Mounting Compressor Unit Features:

Features:

- Evaporator fan is controlled by a separate breaker, it can be set On or Off only when temperature is achieved, this feature allows cool air circulation to maintain constant temperature (default setting)
- Polyurethane thickness is 40kg/m³ using Semi-Automatic machine infusion foaming method to control evenness during process.
- Door frame heater stop working when temperature is achieved, its meant to reduce electrical consumption plus prolong heater life span.
- Top mounted compressor unit c/w recess feature, allows maximum storage space and 100% retractable & removable for servicing
- Supplied with condensor filter for easy cleaning and maintenance
- Micro computer controlled systems for easy monitoring and functioning
- Fabricated from the best quality components, designed to perform with the highest efficiency, economical in pricing, superior in food safety and the best value for the customers
- Stainless Steel Doors, c/w the finest finishing. Using thick stainless steel plates for higher tensile strength, fewer dents and scratches
- Specially designed cooling system with high ambient working temperature, allows food to be chilled at a lower temperature for best food preservation and longer times
- Special designed door gasket, allows "excellent" door sealing effects and is easy to change and clean



- 1 Removable door gasket
- 2 Ergonomic door handle
- 3 Plug in cooling system
- 4 Intelligent PCB board
- 5 Evaporator with led lighting system
- 6 Removable filter

Commercial Refrigerator & Freezers

Delivering superior performance to the World.



TFC-62-1D/2D
TFF-62-1D/2D
TFCF-62-SC-1D/2D

TFC-122-2D/4D
TFF-122-2D/4D
TFCF-122-2D/4D

TFC-183-3D/6D
TFF-183-3D/6D

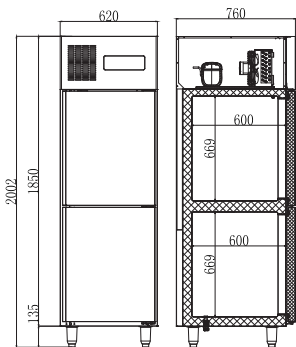

No. 1-5

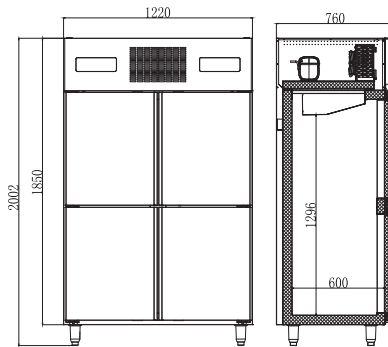

No. 6-10

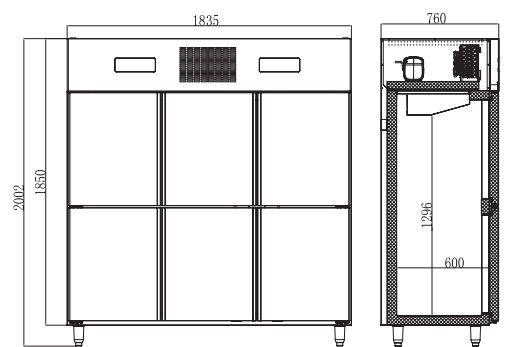

No. 11-14

Upright Dimension

No.	Model	Specifications	Dimensions (mm)	Capacity (Liters)	Temperature Range	Compressor Wattage	Net Weight (KG)	Number of Shelves	List Price
1	TFC-62-1D	1 Door Upright Chiller	620 x 760 x 2002	450	0 ~ +10°C	357w	93	3	USD 1,282
2	TFF-62-1D	1 Door Upright Freezer			-10 ~ -22°C	497w	95		USD 1,456
3	TFC-62-2D	2 Door Upright Chiller	620 x 760 x 2002	450	0 ~ +10°C	357w	95	3	USD 1,256
4	TFF-62-2D	2 Door Upright Freezer			-10 ~ -22°C	497w	97		USD 1,396
5	TFCF-62-SC-2DS	2 door Upright Combination			504w	91	2	USD 1,323	
6	TFC-122-2D	2 Door Upright Chiller	1220 x 760 x 2002	950	0 ~ +10°C	504w	140	6	USD 1,802
7	TFF-122-2D	2 Door Upright Freezer			-10 ~ -22°C	645w	143		USD 2,010
8	TFC-122-4D	4 Door Upright Chiller	1220 x 760 x 2002	950	0 ~ +10°C	504w	145	6	USD 1,703
9	TFF-122-4D	4 Door Upright Freezer			-10 ~ -22°C	645w	147		USD 1,877
10	TFCF-122-4D	4 door Upright Combination			497w	168	USD 2,293		
11	TFC-183-3D	3 Door Upright Chiller	1835 x 760 x 2002	1500	0 ~ +10°C	714w	112	9	USD 2,496
12	TFF-183-3D	3 Door Upright Freezer			-10 ~ -22°C	1517w	115		USD 2,842
13	TFC-183-6D	6 Door Upright Chiller	1835 x 760 x 2002	1500	0 ~ +10°C	714w	118	9	USD 2,600
14	TFF-183-6D	6 Door Upright Freezer			-10 ~ -22°C	1517w	120		USD 2,946

Commercial Refrigerator & Freezers

Delivering superior performance to the World.



Side Mounting Compressor Unit Features:

Features:

- Evaporator fan is controlled by a separate breaker, it can be set On or Off only when temperature is achieved, this feature allows cool air circulation to maintain constant temperature (default setting)
- Polyurethane thickness is 40kg/m³ using Semi-Automatic machine infusion foaming method to control evenness during process.
- Door frame heater stop working when temperature is achieved, its meant to reduce electrical consumption plus prolong heater life span.
- Slim compressor compartment, for maximum storage space
- Draw out type compressor compartment, which is 100% retractable & removable for ease of servicing
- Supplied with condenser filter for easy cleaning and maintenance
- Micro computer controlled systems for easy monitoring and functioning
- Fabricated from the best quality components, designed to perform with the highest efficiency, economical in pricing, superior in food safety and the best value for the customers
- Stainless Steel Doors, c/w the finest finishing. Using thick stainless steel plates for higher tensile strength, fewer dents and scratches
- Specially designed cooling system with high ambient working temperature, allows food to be chilled at a lower temperature for best food preservation and longer times
- Special designed door gasket, allows "excellent" door sealing effects and is easy to change and clean
- Adjustable, heavy duty PVC coated shelves



- 1 Removable door gasket
- 2 Ergonomic door handle
- 3 Thick hinge plate
- 4 Led lighting
- 5 Intelligent PCB board
- 6 Condenser bottom heat discharge

Commercial Refrigerator & Freezers

Delivering superior performance to the World.



TFUC-12-2D
TFUF-12-2D

TFUC-15-2D
TFUF-15-2D

TFUC-18-3D
TFUF-18-3D

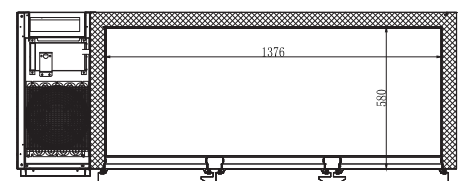
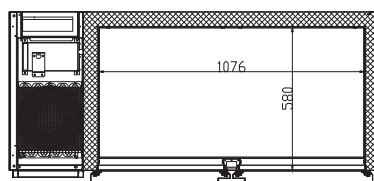
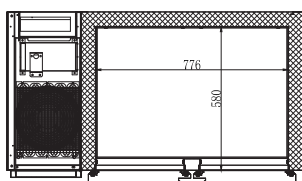
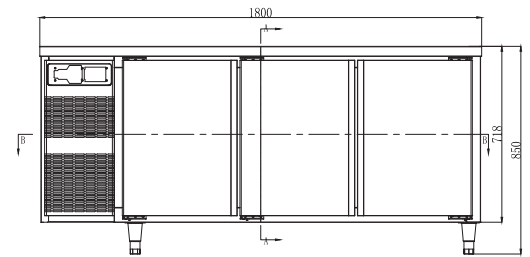
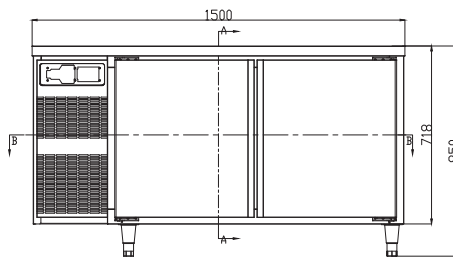
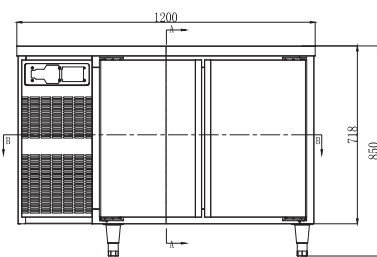

Undercounter Dimension

No.	Model	Specifications	Dimensions (mm)	Capacity (Liters)	Temperature Range	Compressor Wattage	Net Weight (KG)	Number of Shelves	List Price
1	TFUC-12-2D	2 Door Undercounter Chiller	1200 X 700 X 850	252	0 ~ +10°C	357	87	2	USD 1,204
2	TFUF-12-2D	2 Door Undercounter Freezer			-10 ~ -18°C	358	90	2	USD 1,362
3	TFUC-15-2D	2 Door Undercounter Chiller	1500 X 700 X 850	325	0 ~ +10°C	357	97	2	USD 1,347
4	TFUF-15-2D	2 Door Undercounter Freezer			-10 ~ -18°C	358	100	2	USD 1,508
5	TFUC-18-3D	3 Door Undercounter Chiller	1800 X 700 X 850	455	0 ~ +10°C	357	108	3	USD 1,464
6	TFUF-18-3D	3 Door Undercounter Freezer			-10 ~ -18°C	497	121	3	USD 1,633



www.kxports.com

USP

INTELLIGENT
PCB BOARD



THICK DOOR
GASKET



SELF CLOSING
DOOR

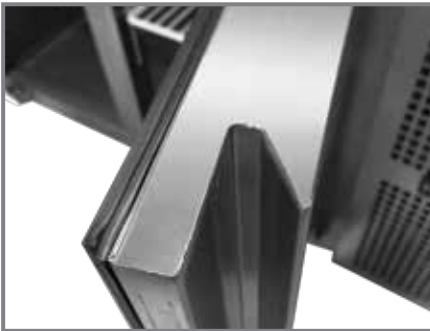

COOLING
SYSTEM



THICK HINGE
PLATE



SELF
EVAPORATING
PAN



LED LIGHTS



1. Internal LED lights for undercounter & upright models.
2. Changeable door direction
3. Condenser bottom heat discharge
4. Aluminium casing for evaporating pan
5. Compressor fan
6. Dust filter
7. Adjustable bullet feet or castors
8. Recess available for electrical point (only undercounter models)



Agent/Distributor

Kxports SG Pte Ltd
Blk 5012 #04-12 Ang Mo Kio Avenue 5
Techplace 2
Singapore 569876
Website : www.kxports.com